



Date: January 30, 2023 to February 24, 2023

Location: Virtual

Topic: U.S. Route 14 at Hartland / Hughes Road Phase I Study
Public Outreach Event #3

Meeting Summary

The third public outreach event for the preliminary engineering and environmental study (Phase I) of U.S. Route 14 (U.S. 14) at Hartland/Hughes Road was held virtually over a three-week period from January 30 to February 24, 2023 on the project website, www.US14HartlandHughes.com. The outreach event was held virtually in place of an in-person public meeting. The purpose of the outreach event was to:

- To present the Preferred Alternative
- To provide update on the study process

The project website was launched on July 12, 2022, and contained the following webpages:

1. *Project Overview* provided an introduction to the project, a project location map, and project background. This page also contained information related to safety concerns at the project area, including an overview of the Road Safety Review completed in July 2018, short-term countermeasures implemented in summer 2018, and crash data from 2015 to 2018.
2. *Documents* included an embedded video showing a slideshow presentation with voiceover that covered the following topics:
 - a. Study Area Overview
 - b. Recap of Alternatives Analysis and POE #2
 - c. Preferred Alternative
 - d. Next Steps

The *Documents* webpage also included links to download the following exhibits:

- a. Public Outreach Event #3 Newsletter
 - b. Preferred Alternative Exhibit
 - c. Proposed Right-of-Way Exhibit
3. *Virtual Sign-In Sheet* featured a fillable form to allow members of the public to sign in and provide their contact information, to be updated about future outreach events.
 4. *Comment Form* included a fillable form for members of the public to submit a comment, as well as instructions for sending comments by email or by mail. The webpage also included information on available assistance for persons with disabilities and how to obtain hard copies of materials.

Screenshots of the project website and copies of all project exhibits are attached.

Event Advertisement

The meeting was advertised in the following publications on the dates noted, both online and in print.

- Northwest Herald
 - Wednesday, January 25, 2023
 - Wednesday, February 1, 2023
- Woodstock Independent
 - Wednesday, January 25, 2023
 - Wednesday, February 1, 2023



The Illinois Department of Transportation (IDOT) invites you to attend the third virtual public outreach event concerning improvements to the US 14 at Hartland Road/Hughes Road intersection in McHenry County. Instead of hosting a regular public meeting, IDOT will share details on the project and encourage public participation until February 24th through an interactive website.

The website is available now through February 24th, and can be accessed at:

www.US14HartlandHughes.com

Purpose of the outreach event is:

- To present the Preferred Alternative
- To provide updates on the study process

At the website, the public can watch a video about the project, view exhibits, and provide feedback. In addition to the website, IDOT's outreach efforts will include a newsletter mailed to residents of the study area and the opportunity to ask questions to IDOT staff over the phone by calling (847) 705-4569. Comments received by February 24th will become part of the official public outreach record.

Individuals without internet access may contact Anna Kutryn, P.E., Project Manager, at (847) 705-4569 for more information about the project.

All written correspondence regarding this project should be sent to:

Illinois Department of Transportation
Attn: Anna Kutryn, P.E.
Bureau of Programming
201 West Center Court
Schaumburg, IL 60196-1096

Email: US14HartlandHughes@gmail.com

Project website: www.US14HartlandHughes.com

The conducted outreach will be accessible to people with disabilities. Anyone needing special assistance including Spanish interpretation should contact the Project Manager as noted above. Persons who will need a sign language interpreter or other similar accommodations should notify the IDOT's TTY/TTD (866) 273-3681. It may take at least five (5) days to provide accommodations.

A public meeting newsletter was mailed to 191 project stakeholders on January 24, 2023. The newsletter included the following information:

- Overview of the project
- Summary of Improvements to the Profile
- Key components of the Preferred Alternative
- Figures for the profile improvement and Preferred Alternative
- Instructions for providing comments and contact information

In addition, an email was sent to 107 project stakeholders on January 30, 2023, that introduced the project and included a link to the project website and the newsletter as an attachment.

Event Attendance

Between January 30 and February 24, 2022 (end of event), a total of 382 unique visitors viewed the site a total of 405 times.

Of the 382 unique visitors, 27 completed the sign-in sheet and provided their name, email address, and mailing address. Based on email and mailing addresses, those who signed in represent the following groups:

- 1 representative from McHenry County
- 1 representative from Woodstock, IL
- 1 representative from Chicago Metropolitan Agency form Planning (CMAP)
- 2 consultants/contractors
- 24 local residents/unaffiliated individuals from the following municipalities:
 - Woodstock - 13
 - Harvard – 4
 - Crystal Lake – 2
 - Cary – 1
 - Idaho Falls – 1
 - McHenry – 1

Comments

16 comments were submitted on the project website between January 30 and February 24, and 1 comment was received via phone call at IDOT. Commenters generally included the following observations:

- 6 described safety issues at the intersection generally
 - 5 mentioned driver behavior as a safety concern
 - 1 mentioned speed as a safety concern
- 8 recommended or advocated for a redesign of the intersection (some included more than one suggestion)
 - 7 recommended a roundabout
 - 1 recommended a traffic light

Comments are attached.

Next Steps

Now that the official comment period has ended, responses to comments will be issued by the Illinois Department of Transportation (IDOT). All public input received at the public outreach event will be included in the project record for the U.S. 14 at Hartland/Hughes Road Phase I Study.

Welcome to the US 14 at Hartland/Hughes Road Virtual Public Outreach Event #3. All of the meeting materials can be viewed in the [Documents](#) tab. Please note all comments received by February 24, 2023 will become part of the Virtual Public Outreach Event record.

×



Project Overview Documents Virtual Sign-In Sheet
Comment Form



Project Overview

Welcome to the US 14 at Hartland/Hughes
Phase I Study

About the Study



The Illinois Department of Transportation (Department) is currently engaged in preliminary engineering and environmental study (Phase I) of the intersection of U.S. Route 14 at Hartland / Hughes Road. The intersection is located in Hartland Township within unincorporated McHenry County. Other nearby communities include the City of Woodstock and the Village of Harvard in McHenry County.

The purpose of the study is to evaluate alternatives to find the most appropriate solution to improve safety and operations at the intersection.

[CONTACT US](#)

Project Background

Annually, the Department performs an analysis of statewide crash data to identify locations with the most pressing safety needs. The

Intersection of U.S. 14 with Hartland / Hughes Road was identified as one of these locations in the past years.

A Road Safety Review completed in July 2018 identified several concerns regarding existing roadway conditions which could be contributing to the crash history of the intersection.

- Speeding on U.S. 14, which is signed for 55 mph, makes it difficult for vehicles on Hartland/Hughes Road to find an acceptable gap to cross or enter U.S. 14
- The hills on U.S. 14 make it difficult to judge the distance of vehicles approaching the intersection
- The lack of left turn lanes creates potential conflicts between turning and through vehicles on U.S. 14
- Narrow corners cause difficulty for turning trucks

Short-term countermeasures were implemented in Summer 2018 to address some of the concerns found by the Road Safety Review.

- Stop bars on Hartland / Hughes Road were moved closer to the intersection to improve drivers' sight distance
- Pavement markings were added on U.S. 14
- Stop signs, advance warning signs, and flashing amber beacons were added on Hartland / Hughes Road to alert drivers of the upcoming intersection

After these countermeasures were added, six crashes were recorded in a one-year period. This Phase I study is to pursue more effective, long-term safety countermeasures at the intersection.

Additional needs to be addressed include drainage and lighting to improve recorded flooding events and improve safety.



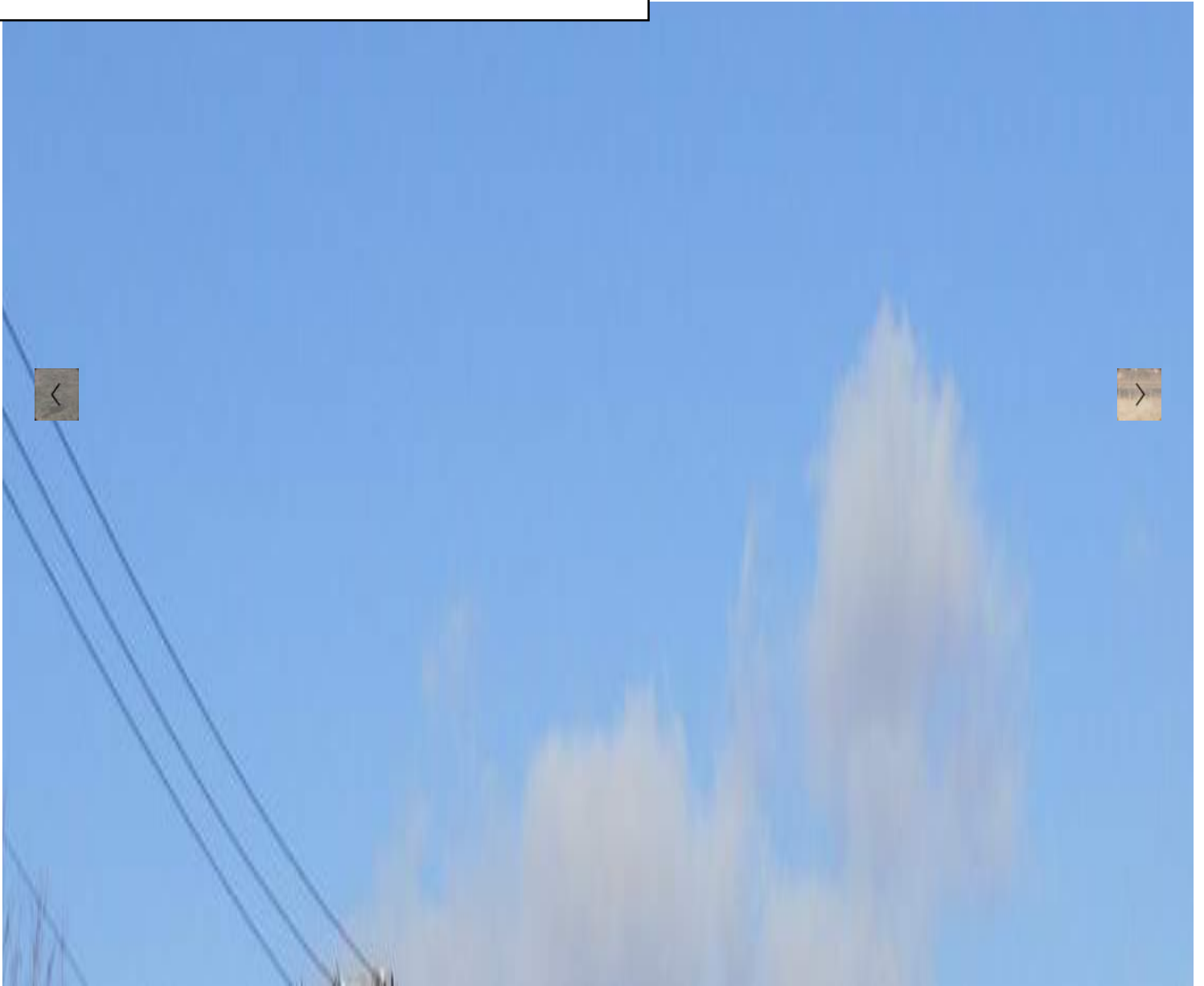

© 2023 Illinois Department of Transportation (IDOT)

Email: US14HartlandHughes@gmail.com

[Get Involved](#)

Welcome to the US 14 at Hartland/Hughes Road Virtual Public Outreach Event #3. All of the meeting materials can be viewed in the [Documents](#) tab. Please note all comments received by February 24, 2023 will become part of the Virtual Public Outreach Event record.

x



[Project Overview](#) [Documents](#) [Virtual Sign-In Sheet](#)
[Comment Form](#)

We'll keep you updated!

Relevant project information are available for viewing here. Updated materials will be added during the study process.

Public Outreach Event #3

[Public Outreach Event #3 Newsletter](#)

[Preferred Alternative Exhibit](#)

[Proposed Right-of-Way Exhibit](#)



US 14 at Hartland/Hughes Road Public Outreach Event #3 Presentation

Epstein

Working Group # 1

[PowerPoint Presentation](#)

[Meeting Summary](#)

Public Outreach Event # 1

[Public Outreach Event #1 Newsletter](#)

[Project Location](#)

[Existing Conditions](#)

[Crash Analysis Exhibit](#)

[PowerPoint Presentation Recording](#)

Working Group #2

[PowerPoint Presentation](#)

[Meeting Summary](#)

Public Outreach Event #2

[Public Outreach Event #2](#)

[Newsletter](#)

[Modified R-cut Alternative](#)

[Exhibit](#)

[Right-In/Right-Out Alternative](#)

[Exhibit](#)

[Roundabout Alternative](#)

[Exhibit](#)

[Alternatives Evaluation](#)

[Summary Exhibit](#)

[PowerPoint Presentation](#)

[Recording](#)

© 2023 Illinois Department of Transportation (IDOT)

Email: US14HartlandHughes@gmail.com

[Get Involved](#)

Welcome to the US 14 at Hartland/Hughes Road Virtual Public Outreach Event #3. All of the meeting materials can be viewed in the [Documents](#) tab. Please note all comments received by February 24, 2023 will become part of the Virtual Public Outreach Event record.



Project Overview Documents Virtual Sign-In Sheet
Comment Form

Let us know you're here!

Sign into our virtual sign-in sheet so we know you visited during this Virtual Public Outreach Event. We will keep you updated as the project progresses by informing you of upcoming public meetings.

Your contact info will never be shared publicly.

If you would like to submit a comment, please do so via the [Comment Form](#).

Name *

First Name

Last Name

Address

Address 1

Address 2

City

State/Province

Zip/Postal Code

Country

Email *

Phone

Phone number is not required to sign into the virtual sign-in sheet

(###)

###

####

Sign In

© 2023 Illinois Department of Transportation (IDOT)

Email: US14HartlandHughes@gmail.com

[Get Involved](#)

Welcome to the US 14 at Hartland/Hughes Road Virtual Public Outreach Event #3. All of the meeting materials can be viewed in the Documents tab. Please note all comments received by February 24, 2023 will become part of the Virtual Public Outreach Event record.

x



Project Overview Documents Virtual Sign-In Sheet
Comment Form

Tell us what you think!

Comments are always welcome! You can submit a comment by filling out the adjacent form or by sending an email to **US14HartlandHughes@gmail.com.**

Prefer pen and paper? No problem! Comments can also be mailed to the following address:

Illinois Department of Transportation
Bureau of Programming
Attn: Anna Kutryn
201 Center Court
Schaumburg, IL 60196

Name *

First Name

Last Name

Affiliation

Address

Not required to submit a comment

Address 1

Address 2

City

State/Province

Please note only comments received before February 24, 2023 will become part of the official public outreach event record.

The outreach efforts are accessible to people with disabilities. Anyone needing special assistance, including Spanish interpretation, should contact the project manager Anna Kutryn via (847) 705-4569. Persons who will need a sign language interpreter or other similar accommodations should notify the Department's TTY/TTD (866) 273-3681. It may take at least five days to provide accommodations.

Hard copy versions of all materials can be requested by submitting a comment using this form.

Zip/Postal Code

Country

Email *

Comment *

Submit Comment

© 2023 Illinois Department of Transportation (IDOT)

Email: US14HartlandHughes@gmail.com

[Get Involved](#)

U.S. Route 14 at Hartland / Hughes Road Phase I Study

Virtual Public Outreach Event #3

A video presentation, exhibits, and additional information about this project is available for viewing on our website.



Ways to Comment



Call
(847) 705-4569



Email
US14HartlandHughes@gmail.com



Website
US14HartlandHughes.com



By Mail
Illinois Dept. of Transportation
Bureau of Programming
Attn: Anna Kutryn
201 Center Court
Schaumburg, IL 60196

The outreach efforts are accessible to people with disabilities. Anyone needing special assistance, including Spanish interpretation, should contact the project manager at (847) 705-4569 for more information. Persons who will need a sign language interpreter or other similar accommodations should notify the Department's TTY/TTD (866) 273-3681. It may take at least five days to provide accommodations.



Illinois Department of Transportation
Division of Highways - District 1
201 W. Center Court
Schaumburg, IL 60196

U.S. Route 14 at Hartland / Hughes Road Phase I Study



The Illinois Department of Transportation (Department) is currently engaged in preliminary engineering and environmental study (Phase I) of the intersection of U.S. Route 14 at Hartland / Hughes Road. The intersection is located in Hartland Township within unincorporated McHenry County. Other nearby communities include the City of Woodstock and the Village of Harvard in McHenry County.

The purpose of the study is to evaluate alternatives to find the most appropriate solution to improve safety and operations at the intersection.

Public Outreach Event #2

The second Public Outreach Event for this study was held virtually over a three-week period from July 18 to August 7, 2022 on the project website. The main purpose of the event was to solicit public input on the three build alternatives considered. During the event, over 480 unique visitors viewed the project website. A total of 42 comments were received during the Public Outreach Event. 34 of the comments were in support of the roundabout alternative.

We need your input! Public Outreach Event #3

The Department is encouraging the public to learn more about the Phase I study of the intersection of US 14 and Hartland/Hughes Road and provide feedback on potential intersection improvements. The Department is particularly interested in comments regarding the proposed design for the roundabout.

Held virtually to protect the health and safety of the public, the virtual Public Outreach Event will include a presentation and the opportunity to provide feedback. All are welcome to participate! Visit the project website US14HartlandHughes.com to view the materials and provide your comments. **Please note all comments received by February 24, 2023 will become part of the virtual event record.**

US14HartlandHughes.com



Project Phases - Idea to Reality



*Funded in FY 2023-2028 Proposed Highway Improvement Program.

The Phase I Study Process

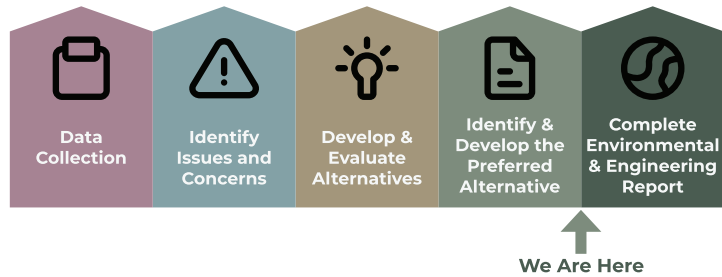

There are several key milestones in a Phase I Study. The Project team has already completed existing data collection, and at the last Public Outreach Event presented the alternatives analysis evaluation. Based on input from the Public and analysis completed a Preferred Alternative has been selected. Over the next few months, the Project team will refine the Preferred Alternative and finalize the engineering and environmental report, the approval of which will conclude this Phase I Study.

Profile Improvements

IDOT has had reports of several incidents of water ponding and overtopping pavement on the southeast corner of the intersection. In order to remedy this problem, the profile will be raised by 5 feet to help reduce the flooding. A culvert will also be installed to allow water to flow from the southeast corner to the southwest corner.

In addition, many of the comments from the Public were concerned with sight distance from the top of the hill east of the US Route 14 at Hartland/Hughes intersection. Raising the profile will help vehicles traveling west along US Route 14 have a better view of the intersection.

The proposed profile raise is illustrated in the graphic below.

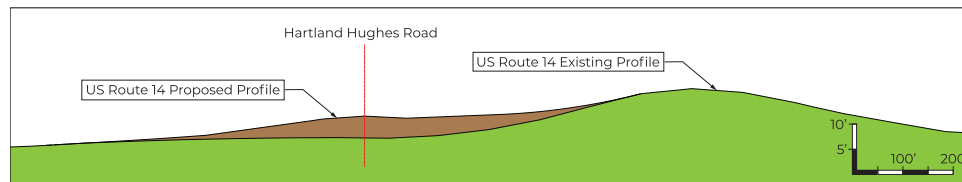

Preferred Alternative

Based on the alternatives analysis and public input gathered at the public outreach events, the Roundabout Alternative was selected as the Preferred Alternative. The roundabout has the least amount of impacts to adjacent properties and wetlands. Because this alternative does not eliminate turning movements it provides better connectivity to adjacent land use and has less impact on the traveling public. The roundabout will also improve safety through this intersection by slowing down traffic as well as improving sight distance by raising the roadway profile. The roundabout also has the lowest estimated improvement cost at \$4.5M.

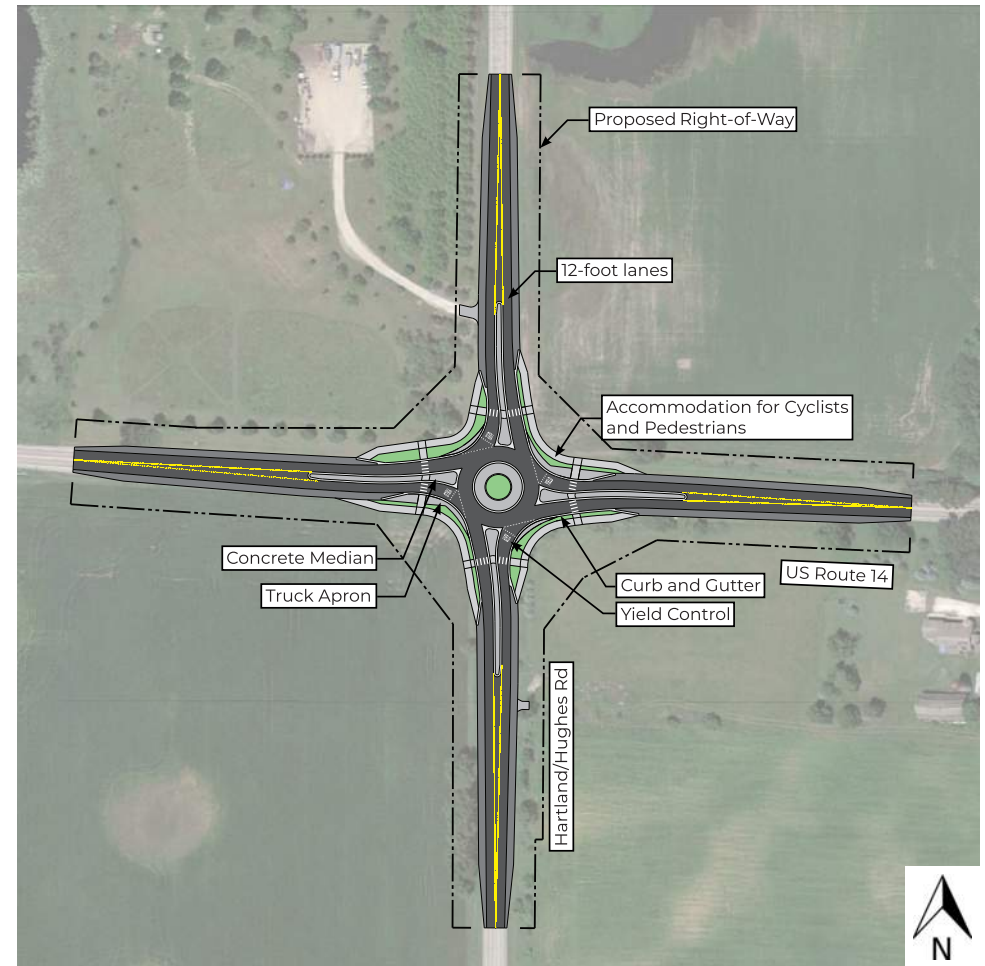



Legend

- Proposed Right-of-Way
- Proposed Temporary Easement



PUBLIC MEETING EXHIBIT - PROPOSED RIGHT-OF-WAY EXHIBIT

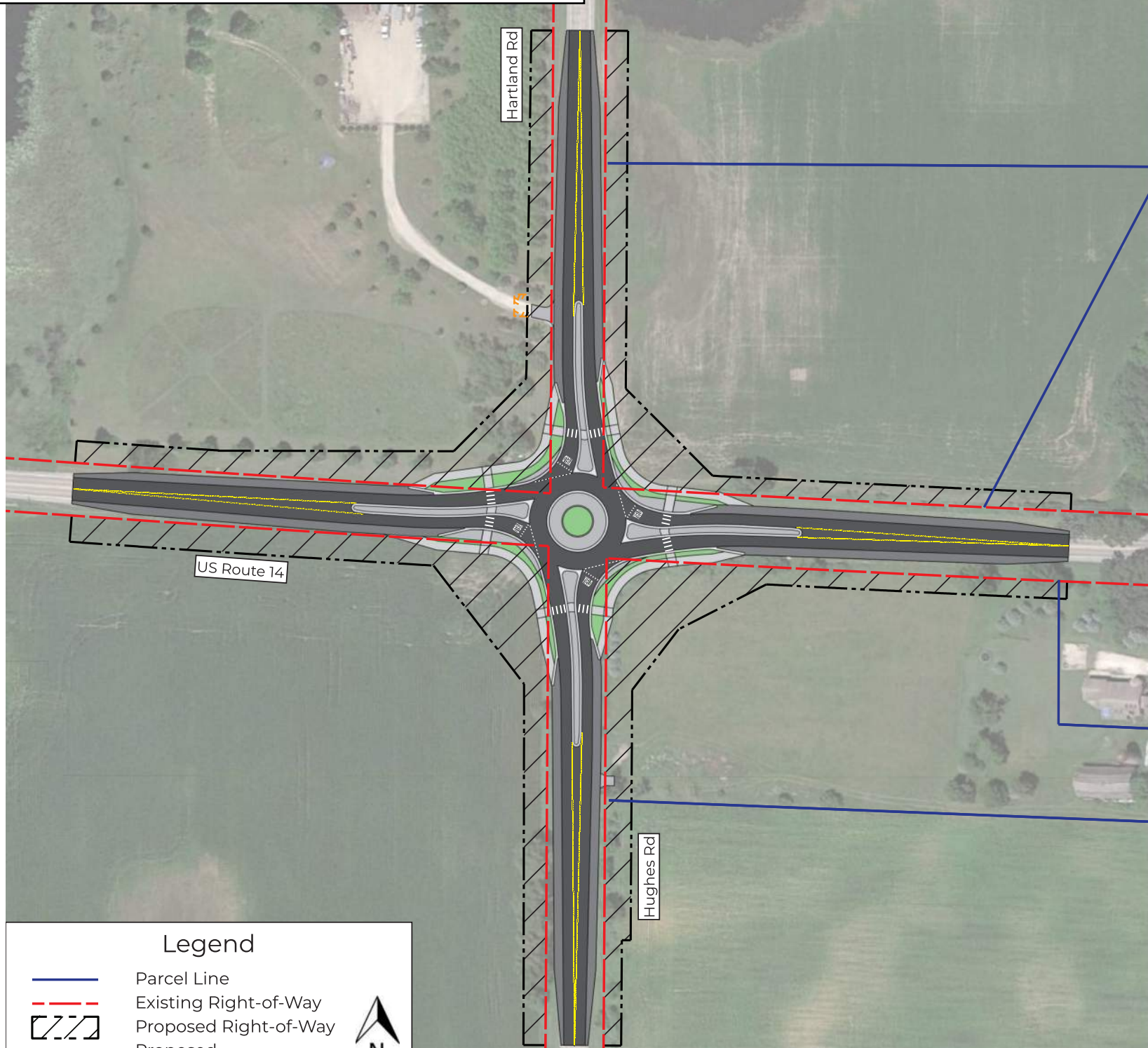

Legend

- Parcel Line
- - - Existing Right-of-Way
- ▨ Proposed Right-of-Way
- - - Proposed Temporary Easement



US 14 at Hartland/Hughes Road Phase I Study

Public Meeting #3 Comments

1	I support your preferred solution of putting in a Roundabout. I'm thankful that you ruled out a traffic signal and more pleased that you didn't opt for a four way stop (even if it wasn't proposed). The objective of intersection improvements should always consider the possibility for a roundabout as they keep the flow of traffic moving without unnecessarily causing backups that result from traffic signals and stop signs. Yes...the public fears them because they have minimal experience with them. So let's keep building them and get drivers accustomed to them.
2	Nowhere in this article does it say where Hartland/Hughes Rd crosses Rt 14. The map is unalterable to enlarge the area shown in order to see where it is.
3	Phase III's Preferred Alternative looks great, since roundabouts are the safest and most economical way to handle vehicular traffic. Traffic signals are a waste of everyone's energy!
4	The advanced signage is extremely important. Drivers on Highway 14 must be informed well in advance that they must SLOW WAY DOWN for the roundabout ahead. I recommend 15 MPH for the roundabout.
5	The worst part about this (for this resident) is collecting mail at the mail boxes that are located across the street from all the residents on the opposite side of the street. Cars traveling at 55+ mph make it not only dangerous but cause someone to run across the road. Any missteps causes the pedestrian potential serious consequences. Can these mail boxes be moved to the opposite side of the street? No one resides on the side of the street where these mail boxes are located
6	Is the round-a-bout going to secure enough R.O.W. should Route 14 in the future go to 4 lanes between Woodstock and Harvard?
7	I prefer the roundabout option. Forcing turners to skip the intersection and/or perform a dangerous U-turn seem like bad
8	A roundabout makes perfect sense at this intersection
9	I frequently travel between Crystal Lake and Harvard and feel the Roundabout proposal would provide the best cost/benefit for this intersection.
10	I have been a regular traveler on this road for over 30 years. In that time I have several times, avoided being T-Boned by cars exiting Hartland road while traveling to Harvard. I do not feel that a roundabout will solve the problem with this particular intersection but more caution lights in all four directions would make a huge impact. The "roundabout" would slow traffic significantly. I feel that the county should "level out the section of Route 14, according to documents. Raising it 5 feet, along with installing a culver, would decrease flooding and increase visibility." Perhaps this might disturb a couple of property owners but it would also make it safer for them to enter and exit driveways. I don't have a solution but I know it's dangerous and I know I slow down everytime I pass that way. I truly feel more flashing lights would help. Especially with the drivers on the Hartland\Hughes road. They always seem to be speeding and take the most risks in crossing or pulling out into traffic due to the slight hills on both sides which they may not realize the drivers are going at least 55 MPH
11	My husband and I drive through that intersection 2-4 times a week. It IS very dangerous because of the hill on 14 and the speed of the traffic. We believe a roundabout would be the best solution.
12	I will start by saying that I dont believe the intersection in its' current configuration isn't dangerous in and of itself, it really falls on to the speed of the drivers on Rt.14 and people on Hartland and Hughes not stopping properly as the driving factors behind the accidents. Given that the speed and patience of drivers are the uncontrolled variables in this equation, would simply adding a well lit 4 way stop be a more cost effective way of slowing traffic down?
13	This intersection is comparable to the Route 20/Harmony Road roundabout already in place. It must be capable to handling truck traffic and - at times - large agricultural machinery. Hughes can be a particularly busy cutoff road at times. It arguably could be the busiest roundabout in the county, so that needs to be taken into consideration
14	This needed to be fixed many yrs ago. In the 80's. People coming from Valley Hi are seniors. They don't know those lonely country roads. Night time is worse. In the 40 plus yrs I've lived here I know personally three deaths on that intersection and four serious accidents. Four were coming or going from Valley Hi! The small rise on Hughes Rd is a problem. If the trees there would have been removed or trimmed that would have helped. The other problem is it's open road. The country. People have their foot on the pedal. More Flashing lights, rumble strips would help. I Love roundabouts, but they're expensive. In the winter just a couple thousand feet to the north the wind swept snow blows across 14. The snow fences help. Now they're gone. Bottom line. It needs to be fixed!
15	After being broadsided by a semi/tractor trailer going at least 55MPH, being pushed down the road 309 ft. and rolled over once, pinned inside the minivan, the semi cab perched on my minivan, needing to be cut out of the vehicle, now having 14 pieces of metal attached to my bones, a traumatic brain injury, and PTSD. My mobility will always be impaired. My preference, since when I travel back to Illinois and Wisconsin to see my family and friends would include this intersection, is to have a complete 4 way traffic light. The proposed improvements, in theory, definitely would make a difference. I feel that a complete traffic light along with posted signs on HartlandHughes stateing the location of the dangerous blind, curve from which the 55MPH traffic is approaching,should be manditory.

16

I STILL FEEL THAT THE US14 - HARTLAND/HUGHES ROUND-ABOUT IS NOT NECESSARY!! YOU ARE WASTING MANY TAX DOLLARS & GOING TO CAUSE MANY HEADACHES & PROBLEMS (WHEN THE CONSTRUCTION BEGINS)!!! THE ACCIDENTS AT THE INTERSECTION ARE CAUSED BY PEOPLE "BLOWING THE STOP SIGN" OR "PULLING OUT INTO TRAFFIC"!! THE HILL TO THE EAST OF THE INTERSECTION NEEDS TO BE CUT DOWN, SO TRAFFIC COMING FROM THE EAST CAN BE SEEN WHEN YOU'RE STOPPED AT THE INTERSECTION -- THIS WOULD ELIMINATE MANY PROBLEMS! RUMBLE STRIPS -- THAT MCHENRY COUNTY DOESN'T USE WOULD BE VERY HELPFUL ON HARTLAND & HUGHES ROAD FOR PEOPLE NOT PAYING ATTENTION!! RAISING THE INTERSECTION 5 FEET IS NOT NECESSARY!! I HAVE LIVED WITHIN 4 MILES OF THIS INTERSECTION FOR OVER 50 YEARS & RARELY DOES WATER SIT ON THE PAVEMENT!! WHAT A WASTE OF MATERIAL & MONEY!! TURN LANES ON RT 14 & ALSO ON HARTLAND/HUGHES ROAD WOULD ALSO BE A GREAT HELP!! GO BACK TO SPRINGFIELD & SIT IN YOUR IVORY TOWER -- ASK THE CITIZENS WHO LIVE IN THE AREA -- AT A PUBLIC MEETING & LISTEN TO THEM -- RATHER THAN ENGINEERS WHO PROBABLY HAVE ONLY VISITED THE SITE ONCE OR TWICE -- GET LOCAL FEEDBACK & NOT THIS TYPE WHERE MANY OF THE LOCAL PEOPLE DON'T KNOW WHAT'S GOING ON!! YOUR PUBLICATION IN THE PAPER DOESN'T MAKE MANY PEOPLE AWARE OF THE PLAN -- SINCE MANY LOCALS DO NOT SUBSCRIBE TO THE PAPER!! ALSO ASK TRUCK DRIVERS WHAT THEY THINK OF YOUR PLANS -- TRUCKERS DO NOT LIKE THEM!! YOUR 2 OTHER PLANS WERE SO "FAR OUT" THAT ONLY A STUPID PERSON WOULD EVEN SUGGEST SUCH A PLAN & ONLY TO MAKE THE ROUND-ABOUT SEEM LIKE A GOOD IDEA!! WANT TO HEAR MORE -- HOLD A MEETING LOCALLY & SEE WHAT IS SAID BEFORE YOU WASTE MORE MONEY!! I'VE RAMBLED ENOUGH BUT I THINK YOU GET MY IDEA & FEELINGS!! I CAN BE REACHED AT [REDACTED] !! THANK YOU!!! [REDACTED]